

iGo[®] everywhere

Install	Page 2
Installation	Page 3
Instalar	Page 4
Installation	Page 5
Installazione	Page 6
Instalar	Page 7
Installatie	Page 8

User Guide

Congratulations on your iGo[®] power purchase! Universally compatible with today's most popular brands, the iGo everywhere power solution allows you to power and charge from any standard wall or in-car outlet. Lose the clutter of all those model-specific chargers and power your mobile phone, Bluetooth[®] headset, smartphone/PDA, MP3 player, portable gaming device, GPS device and more from this convenient power solution (iGo chargers and power tips sold separately).

Specifications:

AC Unit

Input Voltage: 100-240 VAC
Dimensions 82.55 x 50.80 x 25.40mm

In-car Unit

Input Voltage: 11.0-16.5 VDC
Dimensions: 92.20 x 25.40 x 25.40mm

Retractable Cable

Case Dimensions: 55.10 x 66.04 x 23.62mm
Cord Length: 1.52m

Package Contents

- AC unit
- EU and UK plugs
- Retractable cable
- In-car unit
- Travel organizer
- User Guide

www.iGo.com

© 2002-2008 Mobility Electronics, Inc. Mobility Electronics and iGo are registered trademarks and one charger, all your gadgets, simply switch the tip is a trademark of Mobility Electronics, Inc. All other brand names and logos are trademarks of their respective owners. Specifications are subject to change without notice. Protected under one or more of the following patents: 5,347,211; 6,064,177; 6,643,158; 6,650,560; 6,700,808; 6,751,109; 6,775,163; 6,791,853; 6,920,056; 6,937,490; 6,976,885 and 7,153,169. Other United States and foreign patents pending. Made in China. P/N 8040406-01 Rev. A.

A/W P/N: 8330406-01
Rev. A
Material 80g art paper

Install

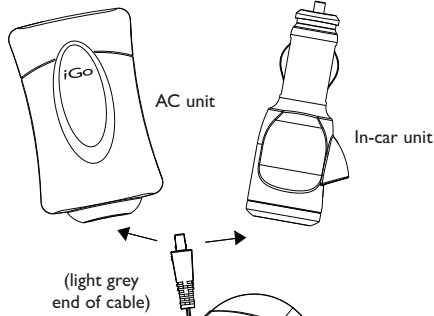

Note:
Pull cable from both sides.

1. Connect the retractable light grey cable end to either the AC or in-car unit.
2. Plug the retractable black cable end to the appropriate iGo power tip.
3. You can now connect to the device you wish to charge.

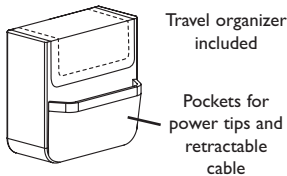

2

Installation

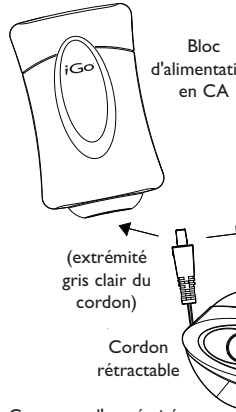

1. Connectez l'extrémité gris clair du cordon rétractable au bloc d'alimentation en CA ou en CC
2. Branchez l'extrémité noire du cordon rétractable au tip d'alimentation iGo approprié
3. Vous pouvez maintenant connecter l'appareil à recharger

Caution: Hold one end of the cable while retracting. Do not let cable retract freely. Cable may jam on reel or whip back and forth and cause injury.

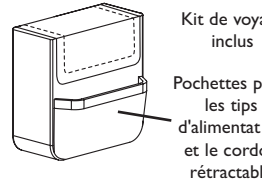

Installation

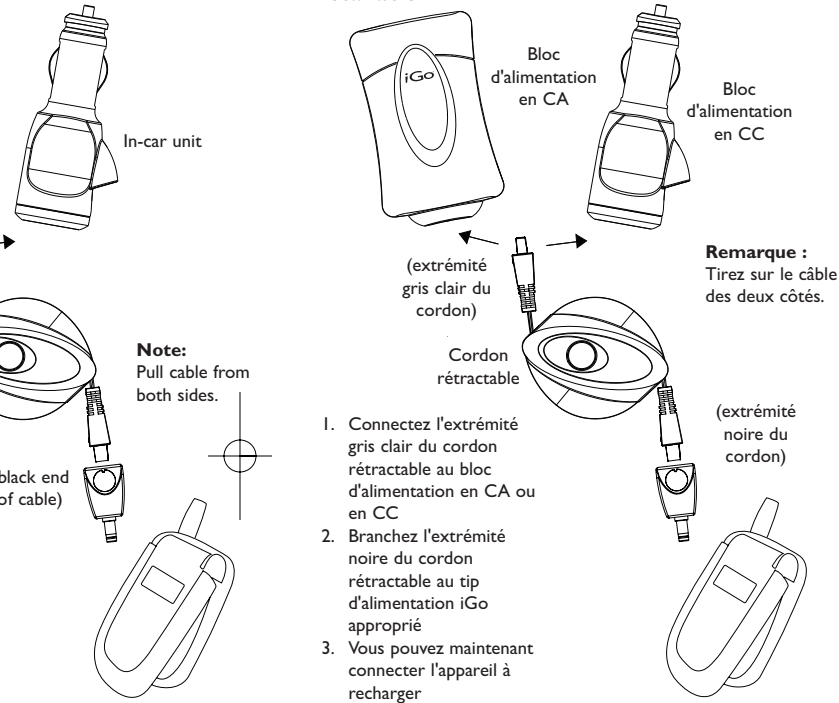

Précaution: Tenez la prise lors de la rétraction du cordon. Guidez le cordon lors de sa rétraction. Le cordon peut se bloquer sur le dévidoir. Il peut également vous blesser s'il génère des mouvements rapides incontrôlés.

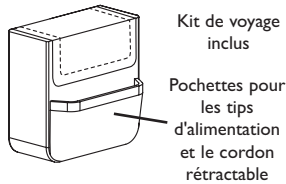

Instalar

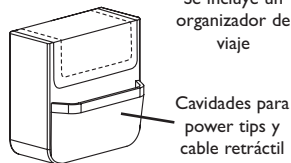
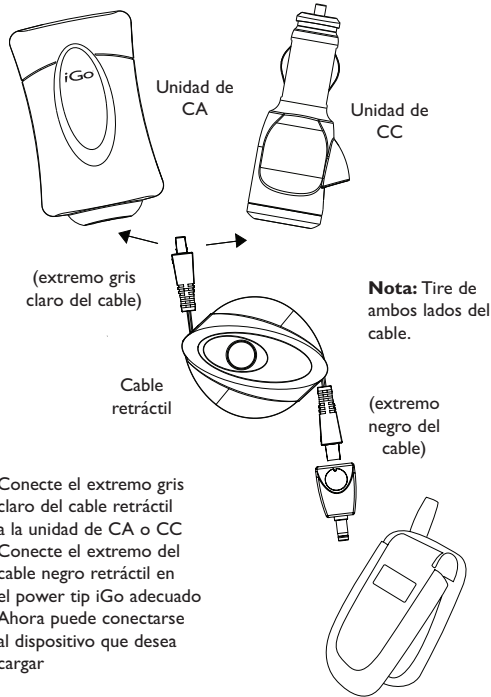

Precaución: Sujete el enchufe mientras se retrae el cable. No deje que el cable se retraiga libremente; podría atascarse en la bobina o golpearle y causarle heridas.

Installation

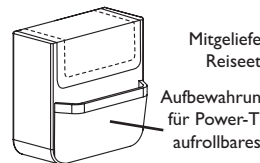
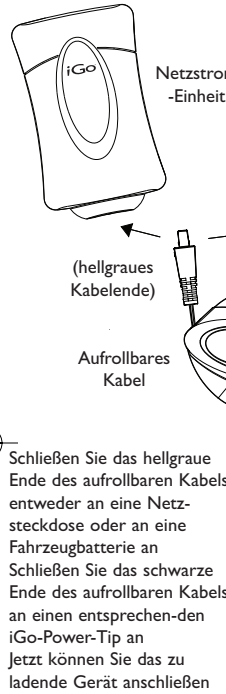

Installation

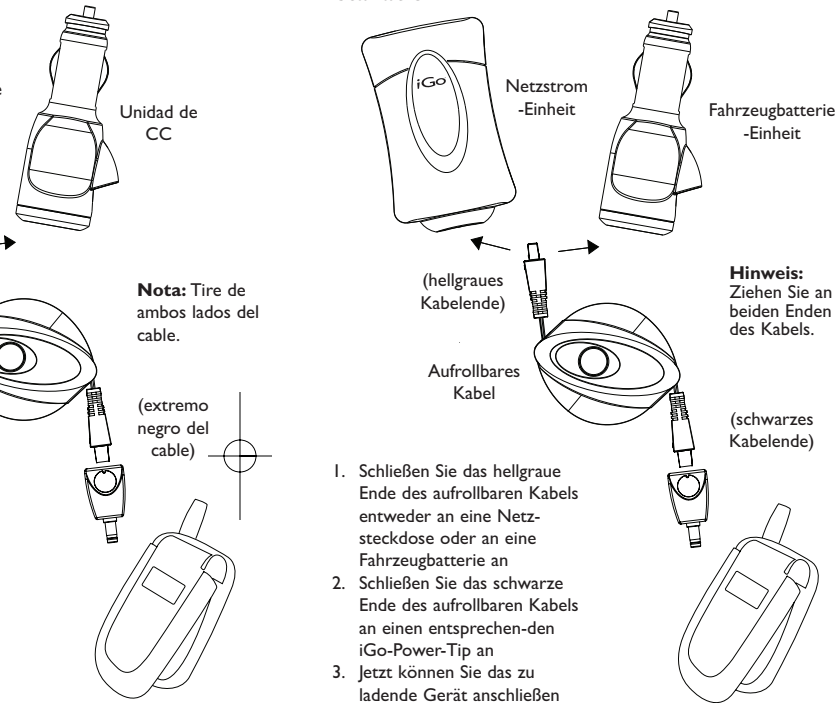

Precaución: Sujete el enchufe mientras se retrae el cable. No deje que el cable se retraiga libremente; podría atascarse en la bobina o golpearle y causarle heridas.

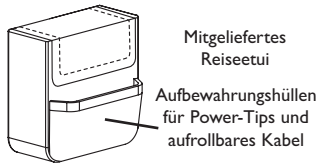

Vorsicht: Halten Sie den Stecker beim Einrollen des Kabels fest. Lassen Sie das Kabel beim Einrollen nicht los. Das Kabel könnte sich sonst beim Einrollen verkleben oder unkontrolliert umherwirbeln und dabei Verletzungen verursachen. 5

Installazione

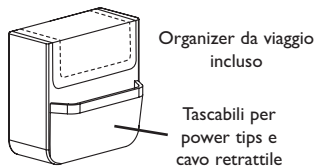
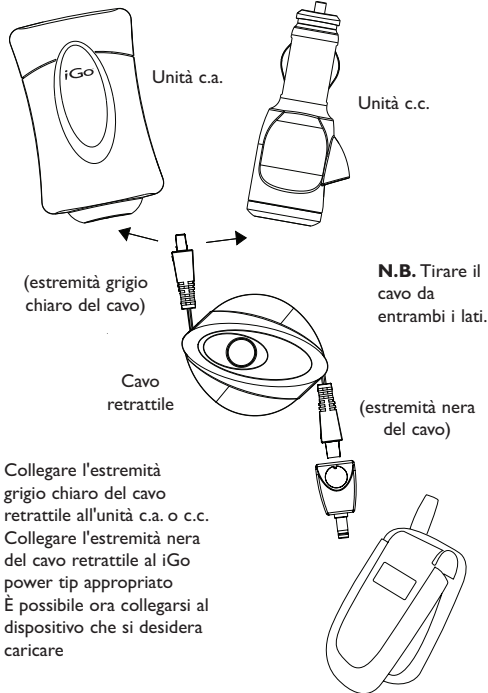

Attenzione: Mantenere la spina mentre si ritrae il cavo. Non lasciare il cavo ritrarsi liberamente. Il cavo potrebbe imbrogliarsi sulla bobina o volteggiare all'improvviso causando lesioni.

Instalar

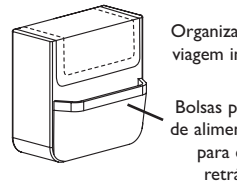
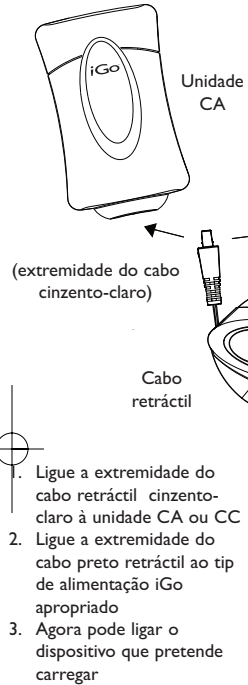

Instalar

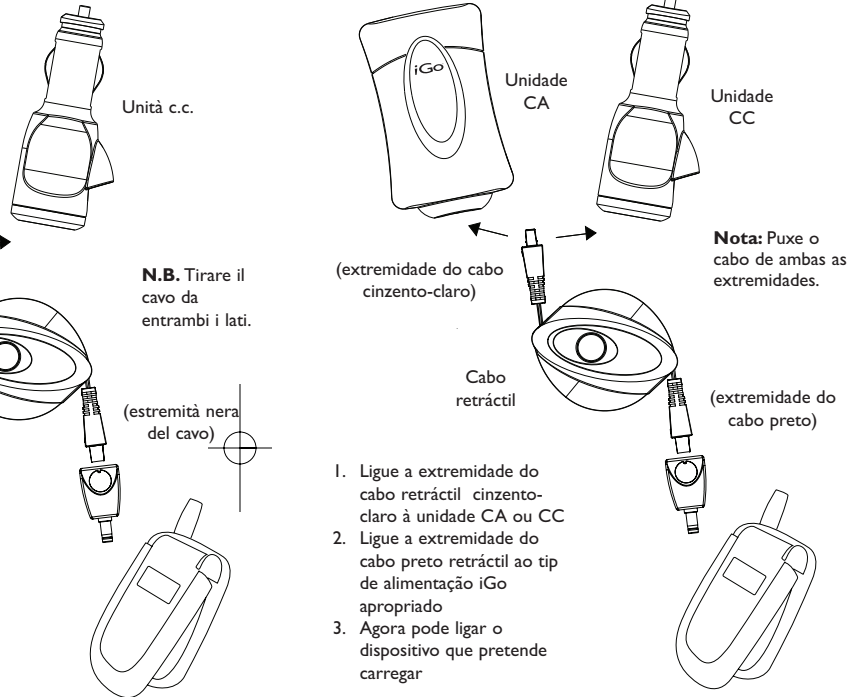

Attenzione: Mantenere la spina mentre si ritrae il cavo. Non lasciare il cavo ritirarsi liberamente. Il cavo potrebbe imbroglarsi sulla bobina o volteggiare all'improvviso causando lesioni.

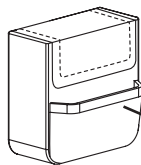

Organizador de viagem incluído

Bolsas para tips de alimentação e para cabo retráctil

Atenção: Segure a ficha enquanto puxa o cabo. Não deixe que o cabo recolha livremente. O cabo pode prender-se na bobina ou soltar-se provocando ferimentos.

Installatie

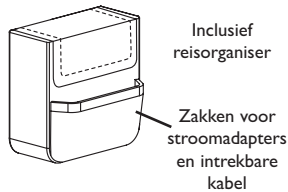
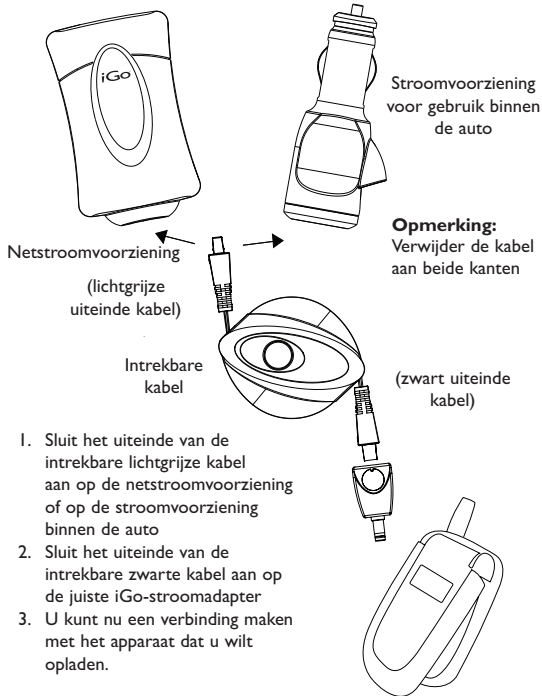

Waarschuwing: zorg ervoor dat u de stekker vasthoudt wanneer u de kabel intrekt. De kabel mag niet ongecontroleerd worden ingetrokken. Hierdoor kan de kabel in de knoop raken op de rol. Daarnaast bestaat er de kans op lichamelijk letsel als gevolg van het rondzwiepen van de kabel.